

EAST HOMESTEAD CDD DISTRICT OWNERSHIP PLAN



FORD ENGINEERS, INC.
1950 N.W. 94th AVENUE, 2nd FLOOR
DORAL, FLORIDA 33172
PH. (305) 477-8472
FAX (305) 470-2805

DRAWINGS AND SPECIFICATIONS AS INSTRUMENTS OF SERVICE ARE AND SHALL REMAIN THE PROPERTY OF FORD ENGINEERS, INC. WHETHER THE PROJECT FOR WHICH THEY ARE MADE IS EXECUTED OR NOT. THEY ARE NOT TO BE USED BY OWNER OR OTHER PROJECT ENTITY BY AGREEMENT IN WRITING AND WITH APPROPRIATE COMPENSATION TO FORD ENGINEERS, INC.

RECORD OF REVISION

NO.	DATE	DESCRIPTION
1	6-3-16	2016 UPDATE
2	9-4-19	KINGMAN COMMONS ANNEX SUBDIVISION RENAMING
3	10-14-19	

EAST HOMESTEAD CDD
DISTRICT OWNERSHIP PLAN
EAST HOMESTEAD COMMUNITY DEVELOPMENT DISTRICT

SCALE: AS SHOWN
DESIGNED BY: G.G.
DRAWN BY: J.P.
CHECKED BY: M.E.
SET #: SEE LABEL
DATE: 12-30-08
PROJECT NO: 06-058
SHEET: **MP-1**
1 OF 1

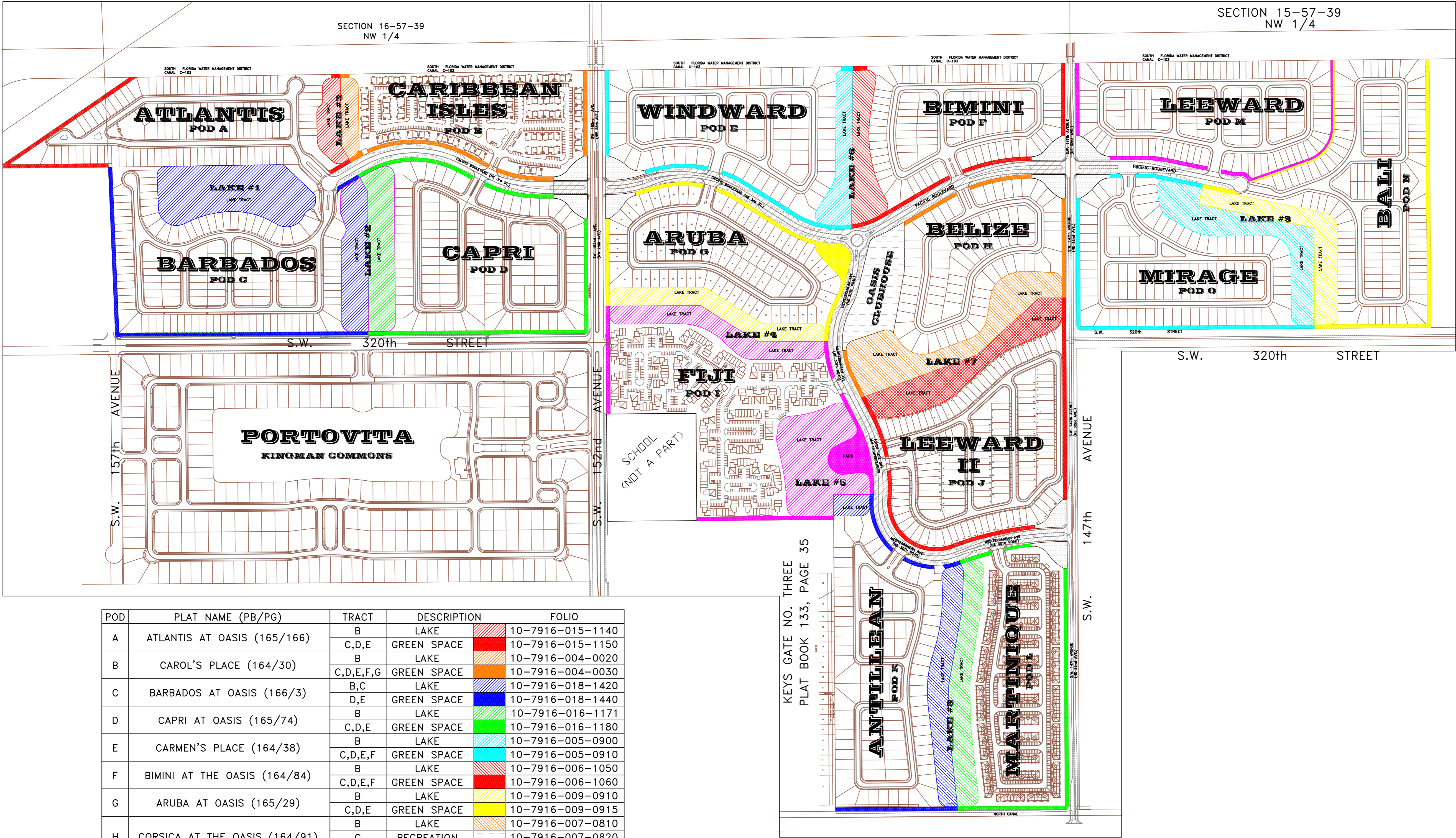

KEYS GATE NO. THREE
PLAT BOOK 133, PAGE 35

LOCATION MAP
SCALE 1"=300'

POD	PLAT NAME (PB/PG)	TRACT	DESCRIPTION	FOLIO
A	ATLANTIS AT OASIS (165/166)	B	LAKE	10-7916-015-1140
		C,D,E	GREEN SPACE	10-7916-015-1150
B	CAROL'S PLACE (164/30)	B	LAKE	10-7916-004-0020
		C,D,E,F,G	GREEN SPACE	10-7916-004-0030
C	BARBADOS AT OASIS (166/3)	B,C	LAKE	10-7916-018-1420
		D,E	GREEN SPACE	10-7916-018-1440
D	CAPRI AT OASIS (165/74)	B	LAKE	10-7916-016-1171
		C,D,E	GREEN SPACE	10-7916-016-1180
E	CARMEN'S PLACE (164/38)	B	LAKE	10-7916-005-0900
		C,D,E,F	GREEN SPACE	10-7916-005-0910
F	BIMINI AT THE OASIS (164/84)	B	LAKE	10-7916-006-1050
		C,D,E,F	GREEN SPACE	10-7916-006-1060
G	ARUBA AT OASIS (165/29)	B	LAKE	10-7916-009-0910
		C,D,E	GREEN SPACE	10-7916-009-0915
H	CORSICA AT THE OASIS (164/91)	B	LAKE	10-7916-007-0810
		C	RECREATION	10-7916-007-0820
		D,E,F,G	GREEN SPACE	10-7916-007-0830
I	AZORES AT OASIS (165/31)	B,C	LAKE	10-7916-010-0020
		D,E,F,G,H	GREEN SPACE	10-7916-010-0030
J	FERNANDO'S PLACE (165/44)	B	LAKE	10-7916-012-1491
		C,D,E	GREEN SPACE	10-7916-012-1500
K	RAUL'S PLACE AT OASIS (165/53)	B,C	LAKE	10-7916-013-0980
		D,E,F,G	GREEN SPACE	10-7916-013-0991
L	MARTINIQUE AT OASIS (165/63)	B	LAKE	10-7916-014-0020
		C,D,E	GREEN SPACE	10-7916-014-0030
M	EMILIO'S PLACE AT OASIS (165/3)	B,C,D	GREEN SPACE	10-7915-002-1450
		B	LAKE	10-7915-004-1420
		C,D,E	GREEN SPACE	10-7915-004-1430
N	BALI AT OASIS (165/7)	B	LAKE	10-7915-003-1000
		C,D,E	GREEN SPACE	10-7915-003-1010
O	ANTIGUA AT OASIS (165/5)	B	LAKE	10-7915-003-1000
		C,D,E	GREEN SPACE	10-7915-003-1010
-	OASIS ROADS (164/27)	A,B,C	ROADWAY	10-7916-027-0020
		D-I,K-M	LANDSCAPE	10-7916-027-0080